

Challenger Door

Process Control Document

Date :10/23/14

Process Title: Sheet :Challenger Screen Latch Retrofit

BY: M.J.S.

Remove the old latch and the 2 catches by removing the 6 screws as shown, and plug with white plastic plugs as shown.

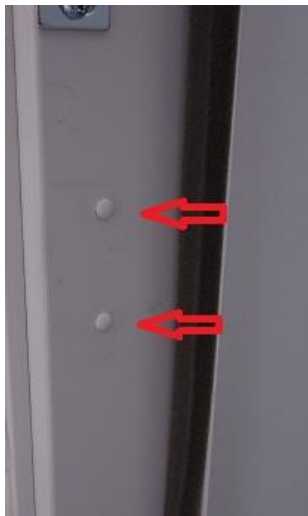
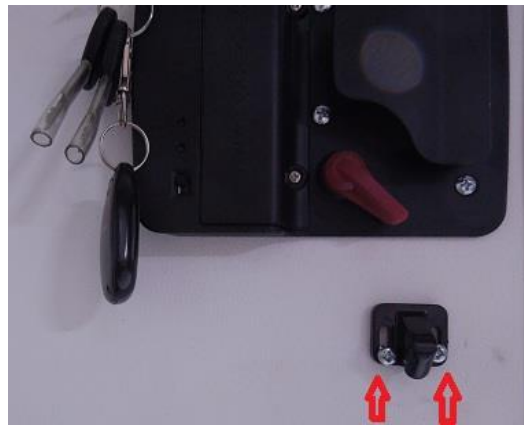

Using template, mark location of the 2 holes and the slot. Cut/drill holes into H-bar.

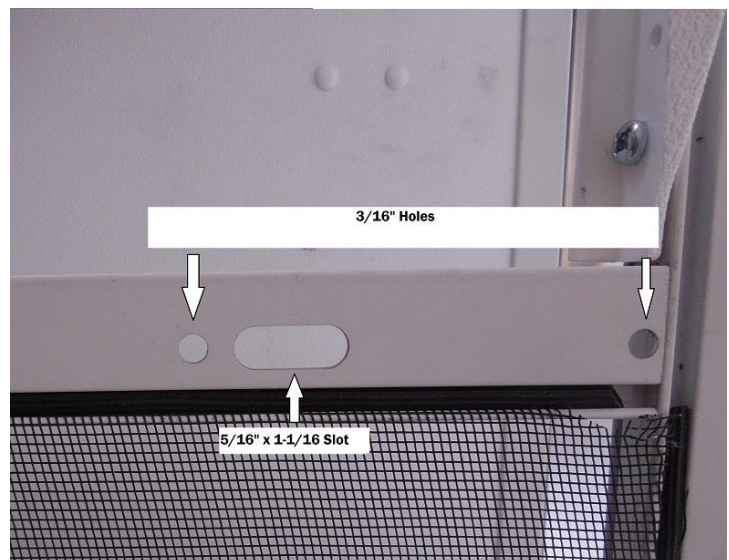

Remove 2 screws from H-bar (lower of the 2 center H-bars). Slide screen latch handle into H-bar as shown, and reinstall the screws. NOTE: Be sure not to move H-bar out more than absolutely necessary.



Prepare to install latch by aligning latch and handle as shown. Using the 2 panhead screws, install the latch. Note 2 different screw lengths, and location for each (as shown below).



Install small “button handle onto latch with the flathead screw.



Mount latch catch onto main door core as shown. Place catch behind screen latch and slide backwards until nose of latch is flush to main body of screen latch. This will determine the location of the catch. Mount catch using 2 screws from old catch that has been removed.

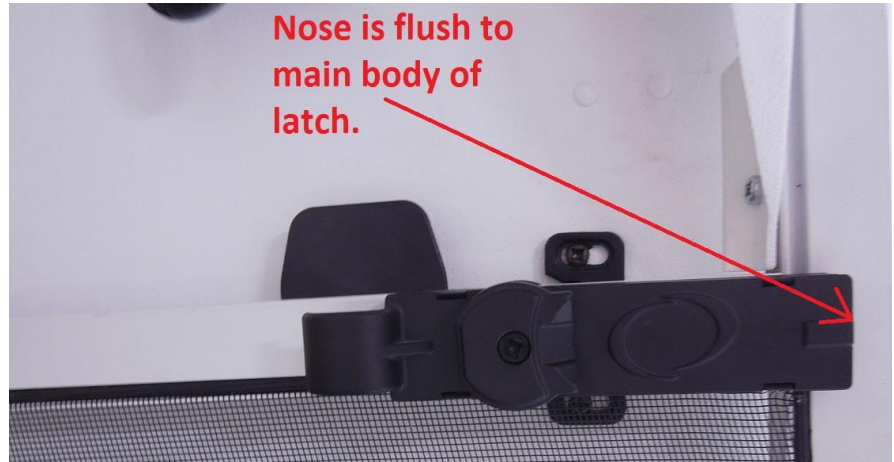

Leaving screen latch retracted and hooked onto catch, close screen door carefully and be sure latch doesn't contact outer frame.

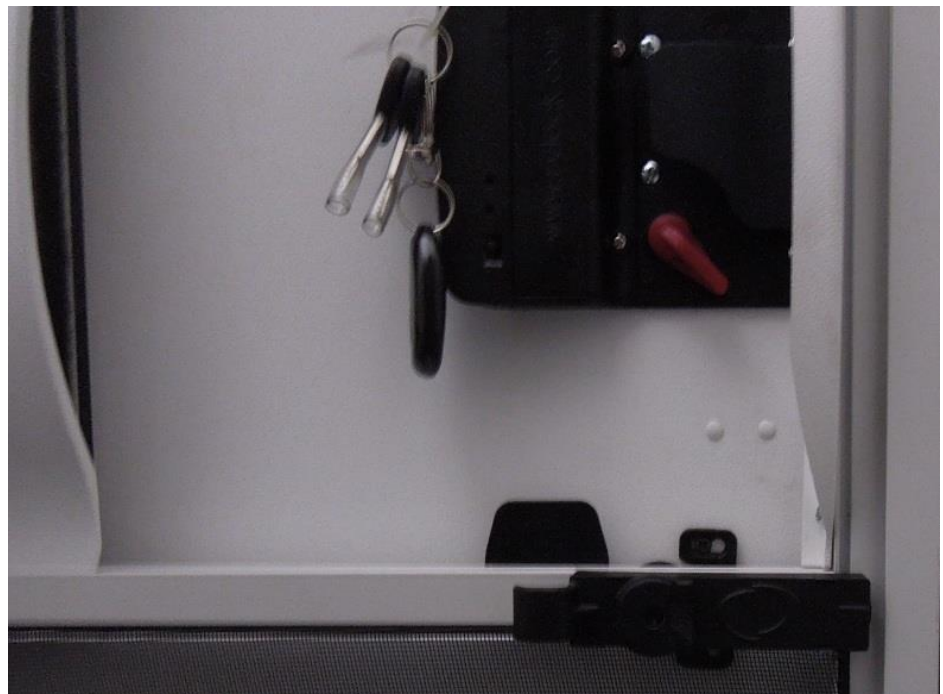

Next unhook screen latch from catch, and close screen door slowly, checking alignment of latch to outer frame. Adjust screen door and/or latch catch as needed to attain proper function.



PARTS:

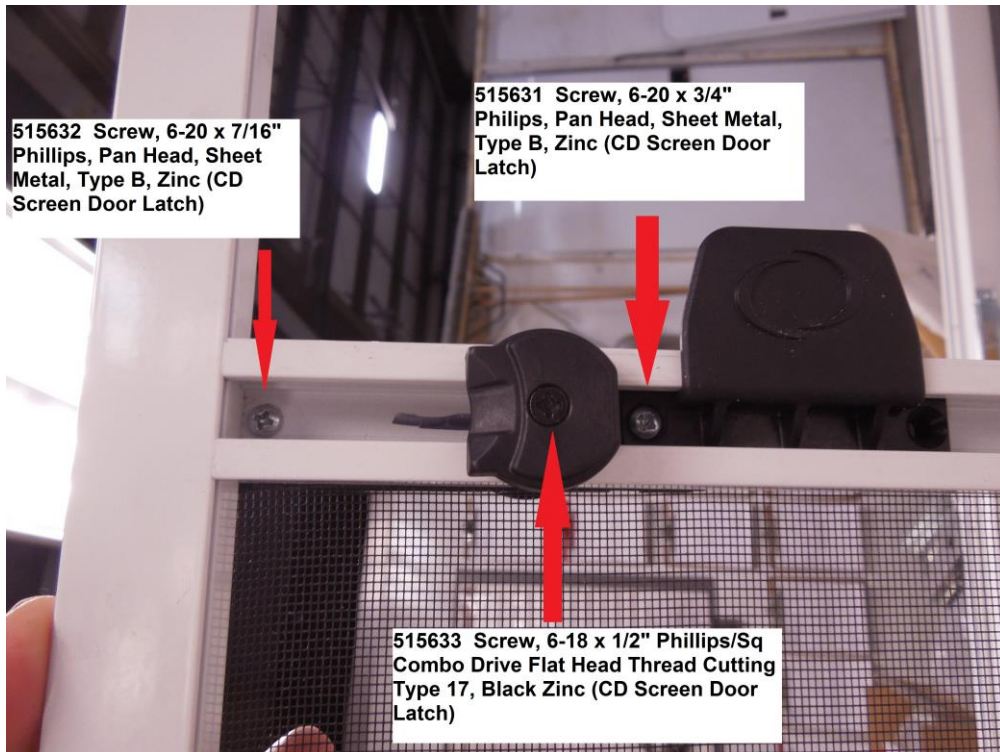



622398

LATCH SCREEN DOOR LATCH HOLDER CATCH



622399

LATCH SCREEN DOOR FINGER PULL BACK

622401 LATCH SCREEN DOOR HANDLE



PARTIALLY ASSEMBLED LATCH



210295 Cosmetic white button .188"