

Challenger Door

Process Control Document

8/1/2016

Andy Yoder

Driver Door Installation

Door and Rough Opening Preparation

1. **Do not remove any shipping clips, spacers, or fasteners. Door must remain closed and locked during the installation.** Opening the door prior to installation will destroy the pre-squaring done by the manufacturer.

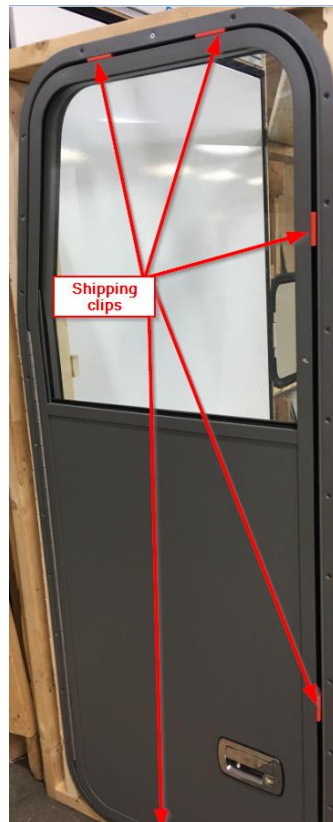

2. Check rough opening to insure that it is both square and plumb. The diagonal measurements should be within $\frac{1}{4}$ inch of each other. A drawing outlining the Rough Opening dimension will be supplied upon request
3. Make certain all mounting surfaces (siding seams included) are securely fastened and flat around perimeter of door opening. Check to see that the floor is free of any debris that might not allow the door to sit level.

Challenger Door

Process Control Document

8/1/2016

Andy Yoder

Driver Door Installation

Door Installation

4. Apply a suitable non-hardening sealant tape to the backside of the door mounting flange and threshold.



5. Insert the door assembly carefully into the rough opening. Make certain the bottom is flat against the floor. Center the door in the rough opening. Insure that the caged nut is free in rough opening as not to cause a bind. Make sure the door mounting flange is seated up against the outside surface of the sidewall.

Challenger Door

Process Control Document

8/1/2016

Andy Yoder

Driver Door Installation

- Fasten the door with screws through the holes in the flange. Drive the first three (3) screws in the middle holes on the hinge side of the frame. Drive the next three (3) screws in the middle holes on the lock side of the frame. Then finish attaching the hinge side of the flange, followed by the lock side, and then the top and bottom. Screws should be driven in straight.

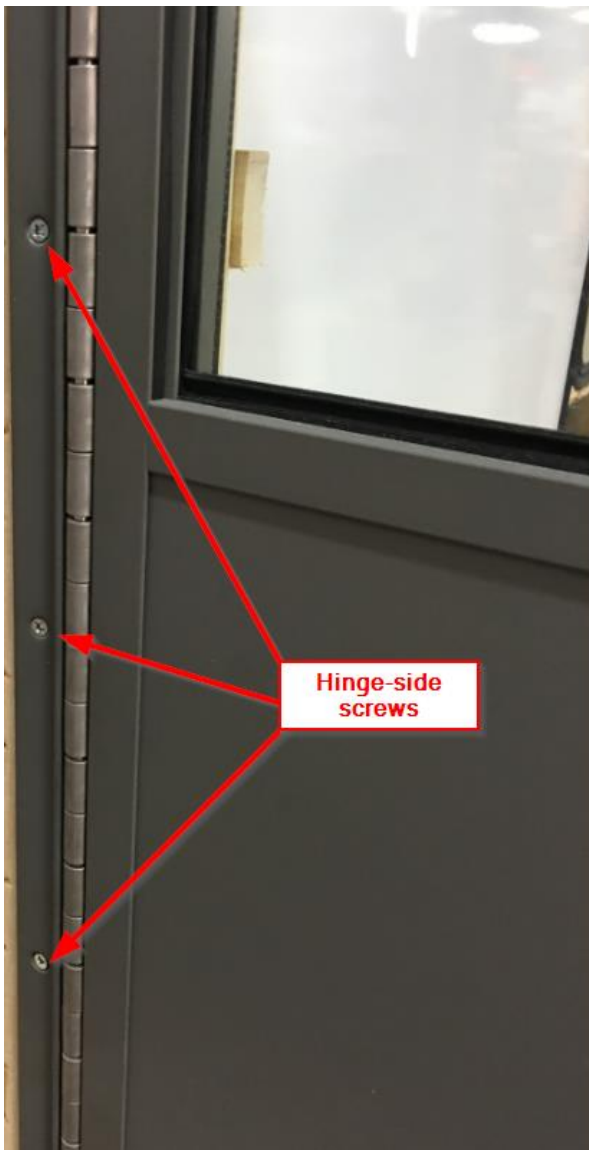

Challenger Door

Process Control Document

8/1/2016

Andy Yoder

Driver Door Installation

7. Open the door and remove the shipping blocks from the door.



Challenger Door

Process Control Document

8/1/2016

Andy Yoder

Driver Door Installation

8. Remove the second screw from the top of the hinge on the wall side and install a #8 x 1.50" Pan Head screw through the hole provided at each hinge tight enough to just contact mounting frame. If door is rubbing on the latch side frame this screw can be used to pull the door more toward the hinge side to keep from hitting the latch side frame.

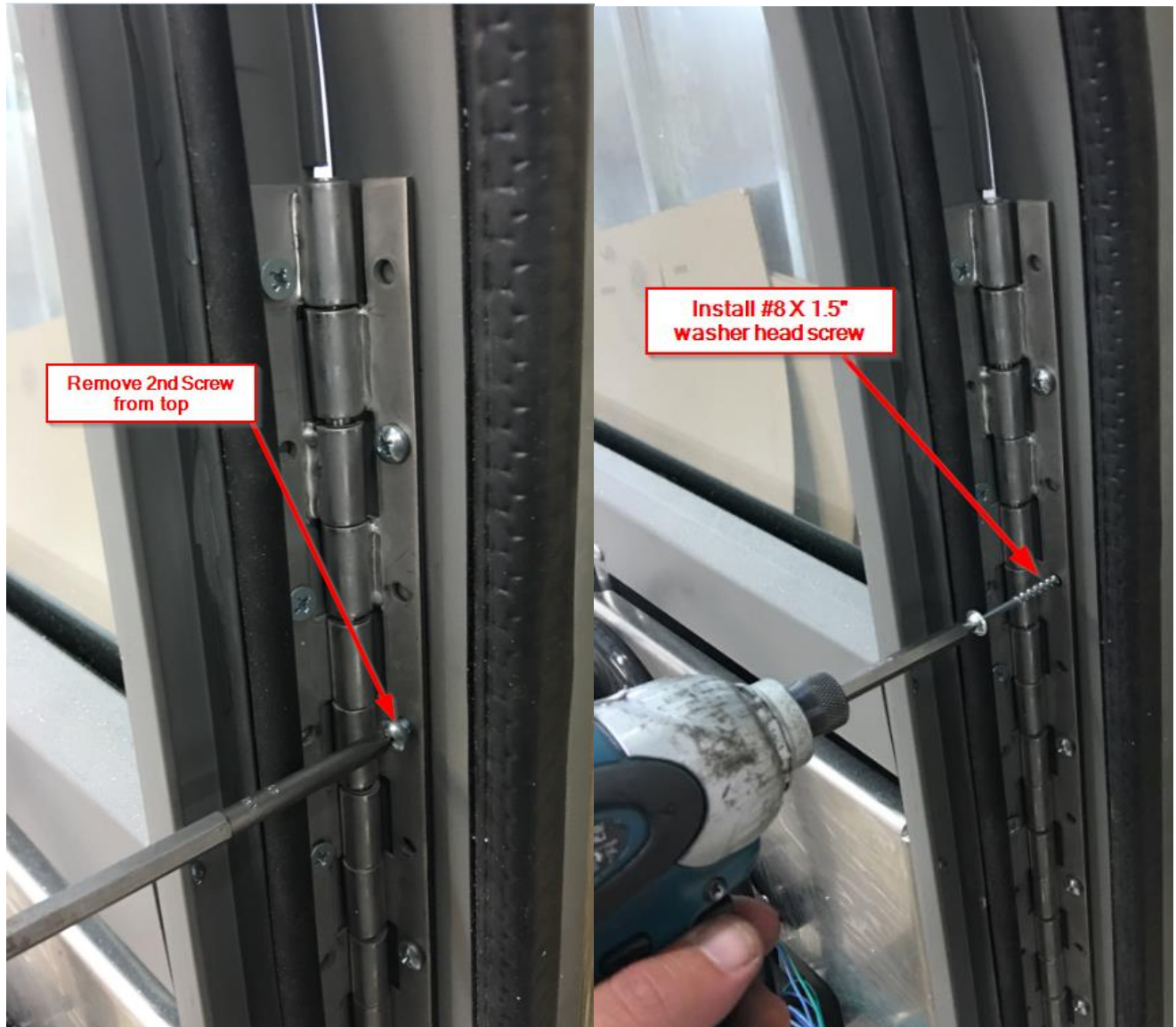

Challenger Door

Process Control Document

8/1/2016

Andy Yoder

Driver Door Installation

9. Close door and check alignment. Adjust striker as necessary, re-torque to 35 ft/lbs.

